

## MUC UNION CROSS

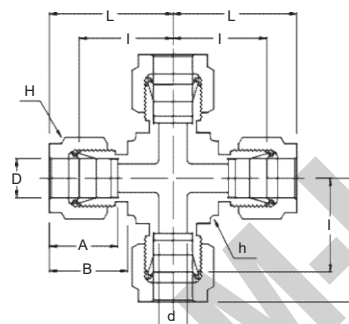

### CONNECTS FRACTIONAL TUBES

Part No.	Tube O.D. D (inch)	d Min	Width Across Flat		A	B	I	L
			h (inch)	H (inch)				
MUC - 1	1/16	1.27	1/2	5/16	8.63	10.92	14.00	18.03
MUC - 2	1/8	2.28	1/2	7/16	12.70	15.24	15.74	22.35
MUC - 3	3/16	3.04	1/2	1/2	13.71	16.00	18.54	25.14
MUC - 4	1/4	4.82	1/2	9/16	15.24	17.78	19.55	26.92
MUC - 5	5/16	6.35	11/16	5/8	16.25	18.54	22.35	29.71
MUC - 6	3/8	7.11	11/16	11/16	16.76	19.30	23.11	30.48
MUC - 8	1/2	10.41	13/16	7/8	22.86	21.84	25.90	36.06
MUC - 10	5/8	12.70	15/16	1	24.38	21.84	28.70	38.80
MUC - 12	3/4	15.74	1-1/16	1-1/8	24.38	21.84	29.71	39.87
MUC - 14	7/8	18.28	1-1/4	1-1/4	25.90	21.84	34.54	44.70
MUC - 16	1	22.35	1-3/8	1-1/2	31.24	26.41	36.83	49.02

MEGALOK VALVES AND FITTINGS INDIA PRIVATE LIMITED

### CONNECTS METRIC TUBES

Part No.	Tube O.D. D	d Min	Width Across Flat		A	B	I	L
			h	H				
MUC - 3M	3	2.4	12.7	12	12.9	15.3	15.7	22.3
MUC - 6M	6	4.8	12.7	14	15.3	17.7	19.6	27.0
MUC - 8M	8	6.4	12.7	16	16.2	18.6	22.4	29.9
MUC - 10M	10	7.9	19	19	17.2	19.5	25.9	33.5
MUC - 12M	12	9.5	20.5	22	22.8	22.0	25.9	36.0
MUC - 16M	16	12.7	24	25	24.4	22.0	26.9	37.0
MUC - 18M	18	15.1	27	30	24.4	22.0	28.2	38.3
MUC - 20M	20	15.9	32	32	26.0	22.0	34.5	44.6
MUC - 25M	25	21.8	36	38	31.3	26.5	36.8	49.1

MEGALOK VALVES AND FITTINGS INDIA PRIVATE LIMITED

- All dimension are in millimeters unless as specified as 'inch'.
- Dimension are for reference only subject to change

M-LOK M-LOK M-LOK M-LOK M-LOK