

**MGMC
MALE CONNECTOR
FOR METAL
GASKET SEAL**

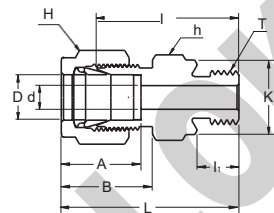

CONNECTS FRACTIONAL TUBE TO FEMALE ISO PARALLEL THREAD

Part No.	Tube O.D. D	T G (PF)	d Min	Width Across Flat		A	B	I	I ₁	L	K
				h	H						
MGMC1N - 2G	1/8	1/8	2.4	9/16	7/16	12.9	15.3	23.4	7.1	30.0	13.8
MGMC2N - 4G	1/8	1/4	2.4	3/4	7/16	12.9	15.3	28.7	11.2	35.3	18.0
MGMC3N - 2G	3/16	1/8	2.4	9/16	7/16	13.7	16.1	24.1	7.1	30.7	13.8
MGMC4N - 2G	1/4	1/8	4.0	9/16	9/16	15.3	17.7	24.9	7.1	32.3	13.8
MGMC4N - 4G	1/4	1/4	4.8	3/4	9/16	15.3	17.7	30.2	11.2	37.6	18.0
MGMC4N - 6G	1/4	3/8	4.8	7/8	9/16	15.3	17.7	31.5	11.2	38.9	21.8
MGMC4N - 8G	1/4	1/2	4.8	1-1/16	9/16	15.3	17.7	37.3	14.2	44.7	26.0
MGMC5N - 2G	5/16	1/8	4.0	9/16	5/8	16.2	18.6	25.7	7.1	33.2	13.8
MGMC5N - 4G	5/16	1/4	6.4	3/4	5/8	16.2	18.6	31.0	11.2	38.5	18.0
MGMC5N - 6G	5/16	3/8	6.4	7/8	5/8	16.2	18.6	32.3	11.2	39.8	21.8
MGMC5N - 8G	5/16	1/2	6.4	1-1/16	5/8	16.2	18.6	38.1	14.2	45.6	26.0
MGMC6N - 4G	3/8	1/4	5.9	3/4	3/4	17.2	19.5	31.8	11.2	39.4	18.0
MGMC6N - 6G	3/8	3/8	7.9	7/8	3/4	17.2	19.5	33.0	11.2	40.6	21.8
MGMC6N - 8G	3/8	1/2	7.9	1-1/16	3/4	17.2	19.5	38.9	14.2	46.5	26.0
MGMC8N - 4G	1/2	1/4	5.9	7/8	7/8	22.8	22.0	32.5	11.2	42.6	18.0
MGMC8N - 6G	1/2	3/8	7.9	7/8	7/8	22.8	22.0	33.0	11.2	43.1	21.8
MGMC8N - 8G	1/2	1/2	9.5	1-1/16	7/8	22.8	22.0	38.9	14.2	49.0	26.0
MGMC8N - 12G	1/2	3/4	9.5	1-3/8	7/8	22.8	22.0	42.7	15.7	52.8	32.0
MGMC9N - 8G	9/16	1/2	11.9	1-1/16	1	24.4	22.0	38.9	14.2	49.0	26.0
MGMC10N - 6G	5/8	3/8	7.9	1	1	24.4	22.0	33.8	11.2	43.9	21.8
MGMC 10N - 8G	5/8	1/2	11.9	1-1/16	1	24.4	22.0	38.9	14.2	49.0	26.0
MGMC 11N - 8G	11/16	1/2	11.9	1-1/16	1-1/4	24.4	22.0	38.9	14.2	49.0	26.0
MGMC 11N - 12G	11/16	3/4	15.1	1-3/8	1-1/4	24.4	22.0	42.7	15.7	52.8	32.0
MGMC12N - 8G	3/4	1/2	11.9	1-1/4	1-1/4	26.0	22.0	40.4	14.2	50.5	26.0
MGMC12N - 12G	3/4	3/4	15.9	1-3/8	1-1/4	26.0	22.0	42.7	15.7	52.8	32.0
MGMC14N - 12G	7/8	3/4	15.9	1-3/8	1-1/4	26.0	22.0	42.7	15.7	52.8	32.0
MGMC14N - 16G	7/8	1	18.3	1-5/8	1-1/4	26.0	22.0	45.2	18.3	55.3	39.0
MGMC15N- 12G	1	3/4	15.9	1-3/8	1-1/2	31.3	26.5	45.2	15.7	57.5	32.0
MGMC15N - 16G	1	1	19.8	1-5/8	1-1/2	31.3	26.5	47.8	18.3	60.1	39.0

MEGALOK VALVES AND FITTINGS INDIA PRIVATE LIMITED

- All dimension are in millimeters unless as specified as 'inch'.
- Dimension are for reference only subject to change

MGMC
MALE CONNECTOR
FOR METAL GASKET
SEAL

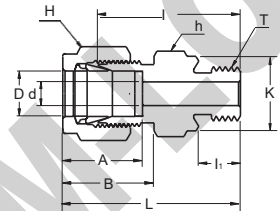

CONNECTS METRIC TUBE TO FEMALE ISO PARALLEL THREAD

Part No.	Tube O.D. D	T G (PF)	d Min	Width Across Flat		A	B	I	I ₁	L	K
				h	H						
MGMC 3M - 2G	3	1/8	2.4	14	12	12.9	15.3	23.4	7.1	30.0	13.8
MGMC 3M - 4G	3	1/4	2.4	19	12	12.9	15.3	28.7	11.2	35.3	18.0
MGMC 4M - 2G	4	1/8	2.4	14	12	13.7	16.1	24.1	7.1	30.7	13.8
MGMC 6M - 2G	6	1/8	4.0	14	14	15.3	17.7	24.9	7.1	32.3	13.8
MGMC 6M - 4G	6	1/4	4.8	19	14	15.3	17.7	30.2	11.2	37.6	18.0
MGMC 6M - 6G	6	3/8	4.8	22	14	15.3	17.7	31.5	11.2	38.9	21.8
MGMC 6M - 8G	6	1/2	4.8	27	14	15.3	17.7	37.3	14.2	44.7	26.0
MGMC 8M - 2G	8	1/8	4.0	15	16	16.2	18.6	25.7	7.1	33.2	13.8
MGMC 8M - 4G	8	1/4	6.4	19	16	16.2	18.6	31.0	11.2	38.5	18.0
MGMC 8M - 6G	8	3/8	6.4	22	16	16.2	18.6	32.3	11.2	39.8	21.8
MGMC 8M - 8G	8	1/2	6.4	27	16	16.2	18.6	38.1	14.2	45.6	26.0
MGMC 10M - 4G	10	1/4	5.9	19	19	17.2	19.5	31.8	11.2	39.4	18.0
MGMC 10M - 6G	10	3/8	7.9	22	19	17.2	19.5	33.0	11.2	40.6	21.8
MGMC 10M - 8G	10	1/2	7.9	27	19	17.2	19.5	38.9	14.2	46.5	26.0
MGMC 12M - 4G	12	1/4	5.9	22	22	22.8	22.0	32.5	11.2	42.6	18.0
MGMC 12M - 6G	12	3/8	7.9	22	22	22.8	22.0	33.0	11.2	43.1	21.8
MGMC 12M - 8G	12	1/2	9.5	27	22	22.8	22.0	38.9	14.2	49.0	26.0
MGMC 12M - 12G	12	3/4	9.5	35	22	22.8	22.0	42.7	15.7	52.8	32.0
MGMC 15M - 8G	15	1/2	11.9	27	25	24.4	22.0	38.9	14.2	49.0	26.0
MGMC 16M - 6G	16	3/8	7.9	24	25	24.4	22.0	33.8	11.2	43.9	21.8
MGMC 16M - 8G	16	1/2	11.9	27	25	24.4	22.0	38.9	14.2	49.0	26.0
MGMC 18M - 8G	18	1/2	11.9	27	30	24.4	22.0	38.9	14.2	49.0	26.0
MGMC 18M - 12G	18	3/4	15.1	35	30	24.4	22.0	42.7	15.7	52.8	32.0
MGMC 20M - 8G	20	1/2	11.9	30	32	26.0	22.0	40.4	14.2	50.5	26.0
MGMC 20M - 12G	20	3/4	15.9	35	32	26.0	22.0	42.7	15.7	52.8	32.0
MGMC 22M - 12G	22	3/4	15.9	35	32	26.0	22.0	42.7	15.7	52.8	32.0
MGMC 22M - 16G	22	1	18.3	41	32	26.0	22.0	45.2	18.3	55.3	39.0
MGMC 25M - 12G	25	3/4	15.9	35	38	31.3	26.5	45.2	15.7	57.5	32.0
MGMC 25M - 16G	25	1	19.8	41	38	31.3	26.5	47.8	18.3	60.1	39.0

MEGALOK VALVES AND FITTINGS INDIA PRIVATE LIMITED

- All dimension are in millimeters unless as specified as 'inch'.
- Dimension are for reference only subject to change