

MMA MALE ADAPTER

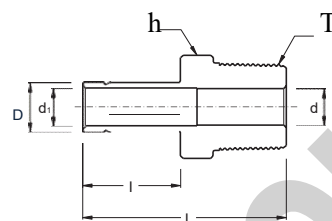

CONNECTS FRACTIONAL M-LOK PORT TO FEMALE NPT THREAD

Part No.	Tube O.D. D (inch)	T* (NPT)	d (Min)	d ₁	Width Across Flat h (inch)	l	L
MMA 2 - 2N	1/8	1/8	4.82	2.10	7/16	13.45	29.50
MMA 2 - 4N	1/8	1/4	7.11	2.10	9/16	13.45	34.80
MMA 3 - 2N	3/16	1/8	4.82	3.04	7/16	14.20	30.22
MMA 3 - 4N	3/16	1/4	7.11	3.04	9/16	14.20	35.56
MMA 4 - 2N	1/4	1/8	4.40	4.40	9/16	15.75	31.80
MMA 4 - 4N	1/4	1/4	4.40	4.40	9/16	15.75	37.08
MMA 4 - 6N	1/4	3/8	4.40	4.40	11/16	15.75	37.84
MMA 4 - 8N	1/4	1/2	4.40	4.40	7/8	15.75	43.43
MMA 5 - 2N	5/16	1/8	4.82	5.60	9/16	16.80	32.76
MMA 5 - 4N	5/16	1/4	6.35	5.60	9/16	16.80	38.10
MMA 6 - 2N	3/8	1/8	4.82	6.90	11/16	17.50	33.50
MMA 6 - 4N	3/8	1/4	6.90	6.90	11/16	17.50	38.90
MMA 6 - 6N	3/8	3/8	6.90	6.90	11/16	17.50	39.60
MMA 6 - 8N	3/8	1/2	6.90	6.90	7/8	17.50	45.20
MMA 8 - 4N	1/2	1/4	7.11	9.40	13/16	23.20	44.50
MMA 8 - 6N	1/2	3/8	9.40	9.40	13/16	23.20	45.20
MMA 8 - 8N	1/2	1/2	9.40	9.40	7/8	23.20	50.80
MMA 10 - 6N	5/8	3/8	9.90	12.00	11/16	24.70	47.40
MMA 10 - 8N	5/8	1/2	12.00	12.00	7/8	24.70	52.30
MMA 10 - 12N	5/8	3/4	14.98	12.00	1-1/16	24.70	52.30
MMA 12 - 8N	3/4	1/2	11.94	14.80	1-1/16	24.70	52.30
MMA 12 - 12N	3/4	3/4	14.80	14.80	1-1/16	24.70	52.30
MMA 12 - 16N	3/4	1	20.32	14.80	1-3/8	24.70	57.91
MMA 14 - 12N	7/8	3/4	14.98	17.27	1-1/16	26.70	54.30
MMA 16 - 12N	1	3/4	15.74	20.40	1-3/8	31.70	58.70
MMA 16 - 16N	1	1	20.40	20.40	1-3/8	31.70	66.00

MEGALOK VALVES AND FITTINGS INDIA PRIVATE LIMITED

CONNECTS METRIC M-LOK PORT TO FEMALE NPT THREAD

Part No.	Tube O.D. (D)	T* (NPT)	d (Min)	d ₁	Width Across Flat (h)	l	L
MMA 6M - 2N	6	1/8	4.1	4.1	11.5	15.75	32.8
MMA 6M - 4N	6	1/4	4.1	4.1	14.2	15.75	38.1
MMA 8M - 4N	8	1/4	5.6	5.6	14.2	16.50	39.1
MMA 10M - 4N	10	1/4	7.1	7.1	14.2	17.50	39.9
MMA 10M - 6N	10	3/8	7.1	7.1	17.4	17.50	40.6
MMA 10M - 8N	10	1/2	11.9	7.1	22.2	17.50	46.2
MMA 12M - 4N	12	1/4	7.1	8.8	17.4	23.50	46.5
MMA 12M - 8N	12	1/2	11.9	8.8	22.2	23.50	52.0
MMA 18M - 12N	18	3/4	15.9	13.9	27	24.90	54.8

MEGALOK VALVES AND FITTINGS INDIA PRIVATE LIMITED

- All dimension are in millimeters unless as specified as 'inch'.
- Dimension are for reference only subject to change