

PART NO	Inlet/Outlet NPT (F)	TOTAL LENGTH	Thickness	Orifie
	A	B	C	O
M-HPBV-4N	1/4 "	66	30	6.4
M-HLPBV-6N	3/8 "	71	32	9.5
M-HLPBV-8N	1/2 "	84	35	12
M-HLPBV-12N	3/4 "	95	50	19
M-HLPBV-16N	1 "	110	56	25

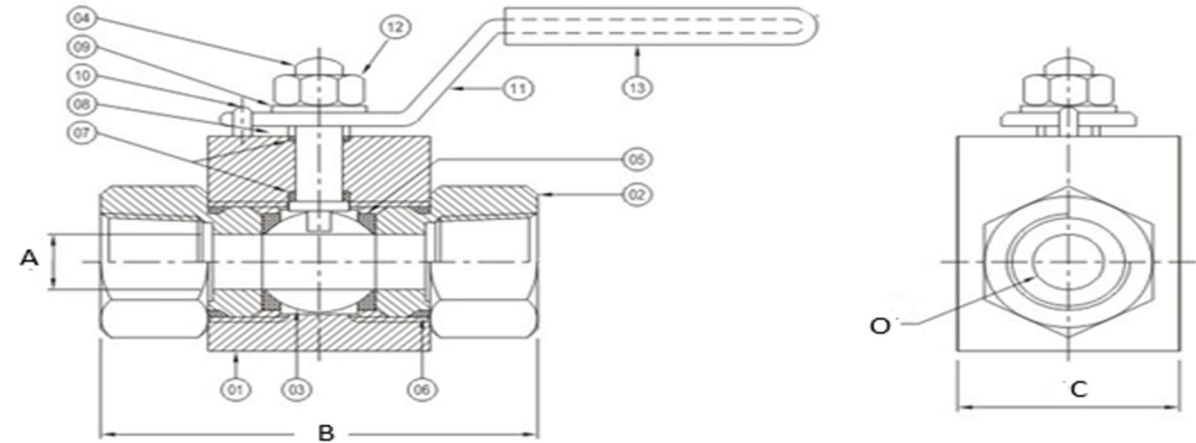

### HIGH PRESSURE BALL VALVE (F X F) 3000 PSI ORDER PART NO+MOC

No	Spare Parts	SS316	SS304	Monal K 400	Inconel 625	Hastealloy C 276	A 105	Qty
1	BODY	SS316	SS304	Monal400	Inconel 625	Hastealloy C 276	A105	1
2	ADAPTER	SS316	SS304	Monal400	Inconel 625	Hastealloy C 276	A105	2
3	BALL	SS316	SS304	Monal400	Inconel 625	Hastealloy C276	A105	1
4	STEM	SS316	SS304	Monal400	Inconel 625	Hastealloy C276	A105	1
5	SEATS	PTEF	PTEF	PTEF	PTEF	PTEF	PTEF	2
6	JOINT SEAL	VITON	VITON	VITON	VITON	VITON	VITON	2
7	GLAND SEALS	PTEF	PTEF	PTEF	PTEF	PTEF	PTEF	2
8	RETAINER	SS316	SS304	Monal400	Inconel 625	Hastealloy C 276	SS304	1
9	WASHER	SS	SS	SS	SS	SS	SS	1
10	STOP PIN	SS	SS	SS	SS	SS	SS	1
11	HANDLE	MS	MS	MS	MS	MS	MS	1
12	NUT	SS	SS	SS	SS	SS	SS	1
13	SLEEVE	PVC	PVC	PVC	PVC	PCV	PVC	1

MEGALOK VALVES AND FITTINGS INDIA PRIVATE LIMITED

- All dimension are in millimeters unless as specified as 'inch'.
- Dimension are for reference only subject to change
- BSP & BSPT available on request