

MC CAP

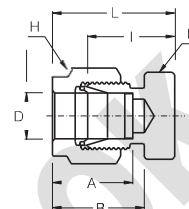

CONNECTS CAPS END OF FRACTIONAL TUBES

Part No.	Tube O.D. (inch)	Width Across Flat		A	B	I	L
		h (inch)	H (inch)				
MC - 1	1/16	5/16	5/16	8.63	10.92	11.20	14.98
MC - 2	1/8	7/16	7/16	12.70	15.24	13.46	20.06
MC - 3	3/16	1/2	1/2	13.71	16.00	14.73	21.33
MC - 4	1/4	9/16	9/16	15.24	17.78	16.00	23.36
MC - 5	5/16	5/8	5/8	16.25	18.54	17.01	24.38
MC - 6	3/8	11/16	11/16	16.76	19.30	18.28	25.65
MC - 8	1/2	13/16	7/8	22.86	21.84	19.05	29.21
MC - 10	5/8	15/16	1	24.38	21.84	19.81	29.97
MC - 12	3/4	1-1/16	1-1/8	24.38	21.84	23.33	33.49
MC - 14	7/8	1-3/16	1-1/4	25.90	21.84	23.87	34.03
MC - 16	1	1-3/8	1-1/2	31.24	26.41	26.16	38.35

CONNECTS METRIC TUBES

Part No.	Tube O.D. MM	Width Across Flat		A	B	I	L
		h	H				
MC -2M	2	11	11	12.9	15.3	13.5	20.1
MC -3M	3	11	11	12.9	15.3	13.5	20.1
MC -4M	4	12	12	13.7	16.1	14.7	21.3
MC -6M	6	14	14	15.3	17.7	15.7	23.1
MC -8M	8	16	16	16.2	18.6	17.0	24.5
MC - 10M	10	19	19	17.2	19.5	19.0	26.6
MC - 12M	12	22	22	22.8	22.0	19.0	29.1
MC - 15M	15	24	25	24.4	22.0	19.8	29.9
MC - 16M	16	24	25	24.4	22.0	19.8	29.9
MC - 18M	18	27	30	24.4	22.0	21.3	31.4
MC - 20M	20	30	32	26.0	22.0	23.9	34.0
MC - 22M	22	30	32	26.0	22.0	23.9	34.0
MC - 25M	25	36	38	31.3	26.5	26.2	38.5

MEGALOK VALVES AND FITTINGS INDIA PRIVATE LIMITED

- All dimension are in millimeters unless as specified as 'inch'.
- Dimension are for reference only subject to change

Installation instruction

1. With wrench, 1-1/4 turn from finger-tight position. (3/4 turn for 1/8, 3/16, 3mm, 4mm)
2. Insert end into cap